

## PU Casing cutter tool

For easy preparation of the pipe ends of the Flexalen PU from coil

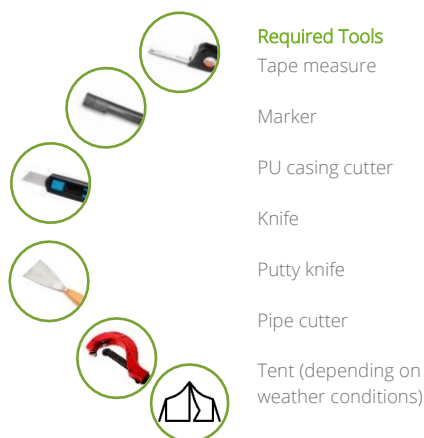

### Required Tools

Tape measure

Marker

PU casing cutter

Knife

Putty knife

Pipe cutter

Tent (depending on weather conditions)

## Application Instruction

### Application conditions and pipe preparation

- Ambient temperature: +5 to +40°C
  - No rainy or windy ( $\geq 3$  bfr / 3.4-5.4 m/s) weather conditions
  - Pipe is without damage
  - Pipe is free from dirt and condensation
- } use a tent to create correct conditions if required

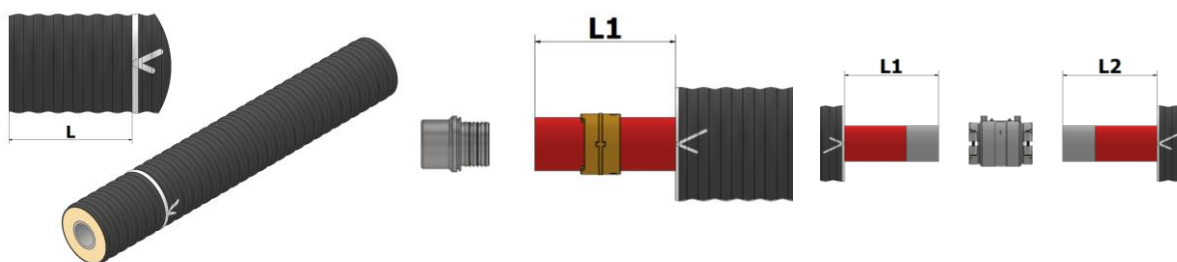

01.

Measure and mark (the complete circumference of the pipe) the length of exposed service pipe required for compression connector or electrofusion fitting installation.

01a.

Installation of compression connector, weld adapter, flange adapter or tread connector and all weldable solutions.

Min. length for pipe sizes PB25 to PB90:  
L1 = 200mm +/- 30mm

Min. length for pipe sizes PB110 and PB125:  
L1 = 250mm +/- 30mm

01b.

For service pipe connections (compressed or welded):

Min. length for pipe sizes PB25 to PB90:  
L1 = L2 = 200mm +/- 10mm

Min. length for pipe sizes PB110 and PB125:  
L1 = L2 = 250mm +/- 10mm

### Disclaimer

All recommendations and information provided on this data sheet are based on our knowledge and experience. Product specifications are intended as guidelines. Since conditions of service are beyond our control, users must satisfy themselves that products are suitable for the intended use. No guarantee or warranty is given or implied or that any use of the products will not infringe rights belonging to other parties. We reserve the right to change product design and properties without notification.

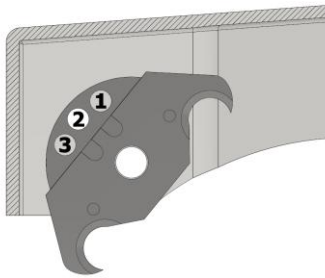

02. Set the PU casing cutter on the right depth setting:  
 1 for casing OD091-OD111  
 2 for casing OD126-OD202  
 3 for casing OD225



03. Place the tool on the marked line and press the knives into the LDPE casing pipe.



04. Cut the complete circumference of the pipe using the ratcheting function of the PU Casing cutter.



05. Use the provide knife with a ballpoint to make an incision in the cut part of the casing.



06. Remove the loose strip of the casing pipe.



07. Carefully cut the outer casing along the pipe axis up to the marked measurement using the PU casing cutter. Apply pressure on the top of the tool to prevent it from jumping out of the casing.

**Attention:** do not damage the surface of the service pipe.



08. Peel of the cut section of the casing pipe.

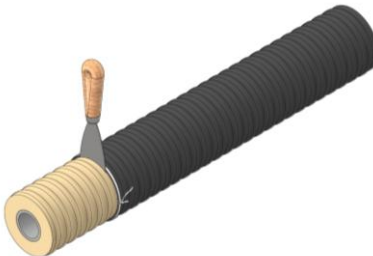

09. Using a putty knife cut the PU insulation loose.

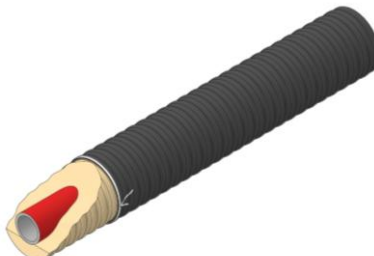

10. Carefully remove the PU insulation foam from the service pipe, by using a putty knife.  
**Attention:** do not damage the surface of the service pipe.



11. To make the pipe end straight, cut around 30mm of the service pipe with a suitable pipe cutter.

**Disclaimer**

All recommendations and information provided on this data sheet are based on our knowledge and experience. Product specifications are intended as guidelines. Since conditions of service are beyond our control, users must satisfy themselves that products are suitable for the intended use. No guarantee or warranty is given or implied or that any use of the products will not infringe rights belonging to other parties. We reserve the right to change product design and properties without notification.